

PLANS NO. 408
 FOR THE
TENTH STREET
 FROM THE EAST LINE OF A STREET TO THE WEST LINE OF WATERMAN AVENUE
 CITY OF SAN BERNARDINO

Sept. 1888

Scale 1"=40'

C.E. Johnson
City Engineer

PLAN



CROSS SECTION - PAVEMENT AT B-B
Scale 1"=40'

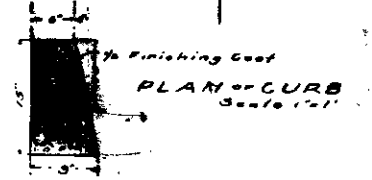

PAVEMENT AT A-A

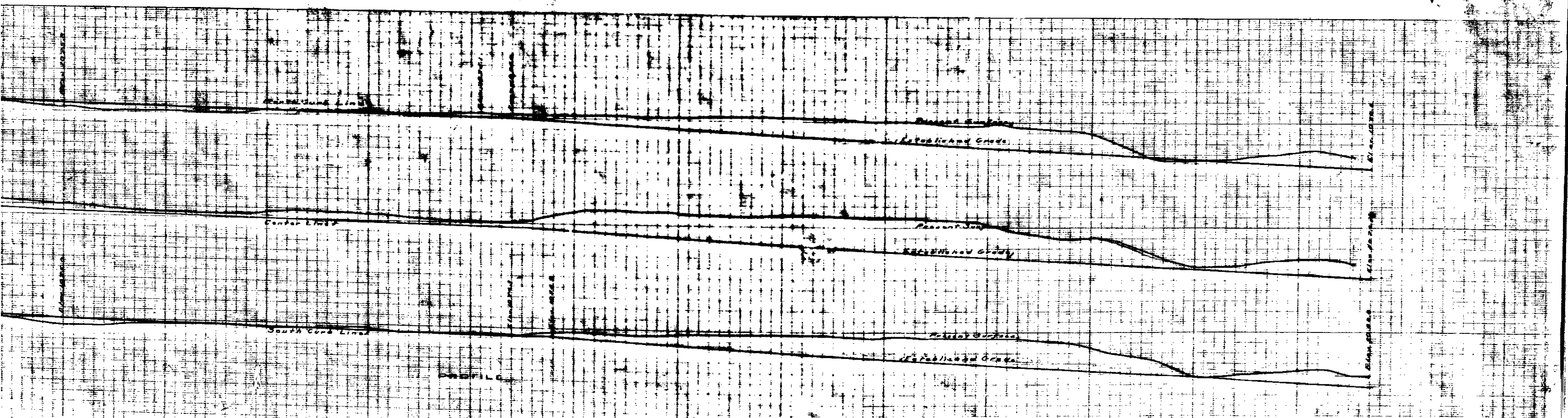

PROFILE

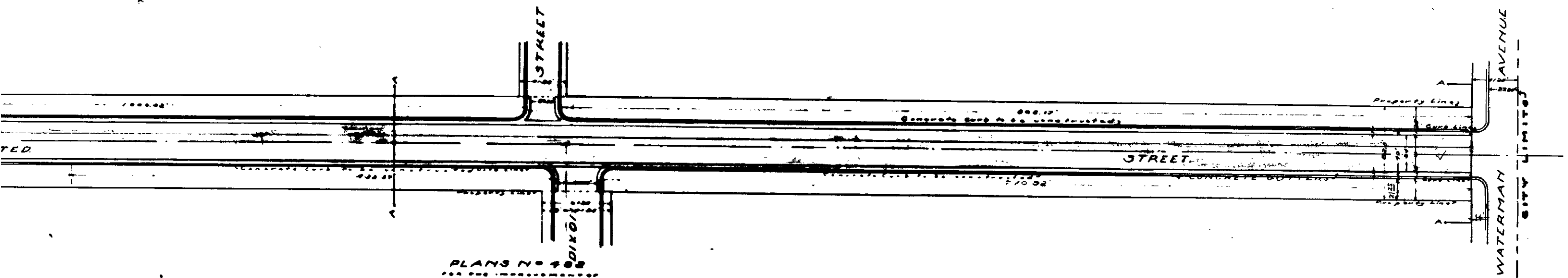

PLANS NO. 408
 FOR THE
TENTH STREET
 FROM THE EAST LINE OF A STREET TO THE WEST LINE OF WATERMAN AVENUE
 CITY OF SAN BERNARDINO

Sept. 1888

Scale 1"=40'

C.E. Johnson
 City Engineer

PLAN



CROSS SECTION - PAVEMENT AT B-B
 Scale 1"=40'

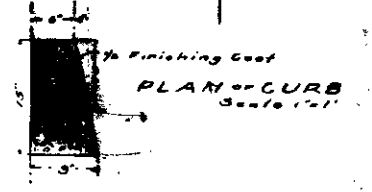

MENT AT A-A

